

FIRE RESISTANT ENCLOSURE FOR RECESSED DOWNLIGHTS

(Page 1)

Note: Correct use of the Isolite™ fire resistant enclosure allows you to avoid up to a 490mm x 490mm insulation void PER downlight, which would destroy insulation and acoustic values. And, because Isolite™ is sealed it brings numerous benefits(details available).

WARNINGS (TO BE READ FIRST)

- DO NOT BEGIN ISOLITE™ INSTALLATION WITHOUT FOLLOWING ALL WARNINGS AND INSTRUCTIONS.** AS/NZS 3000:2007 Wiring Rules clause 4.5.2.3 contains specific minimum safety requirements for all downlight installations and adjacent insulation.
- Before beginning any installation, shut off electrical power supply at main switch.
Note: Wiring connections/disconnections must only be done by a licenced electrician.
- Isolite™ is not recommended for downlights mounted *in* timber/straw panel etc. but it may be installed next to timber as per fig. 1.
- Do not cut open the main body of the Isolite™ Guard, and do not place any objects on top. Offsetting within the Isolite™ Guard base for existing downlights is only acceptable if *all* instructions are met. Under *no* circumstances shall any part of the Isolite™ product (or any adhesive used) be in direct contact with a downlight lamp/globe. New downlights should be positioned for simple enclosure with models I941 or I721.
- Isolite™ Guard must be securely anchored to the ceiling. *Lift the clips of the downlight on top of the I941 or I721 Isolite™ Guard base.* Alternatively, if you are offsetting within the Guard base, where the clips of the downlight will not provide secure permanent anchorage to the entire Isolite™ Guard base, then you must achieve this by another method; Apply an appropriate high strength construction adhesive to the base of two diagonally opposite corners of the Guard and install it on a flat, clean ceiling surface. You must ensure that the Guard is not disturbed before the adhesive is set and sufficiently cured to achieve secure anchorage. In many cases a fast setting adhesive may be the most suitable.
(Note: If you are attaching the Transformer Isolator to the Guard, ensure that it is installed before any adhesive sets).
- Isolite™ Guard *must* only be used to enclose a downlight installed on a flat, clean surface and clear of any dust, build up or obstructions. *No* 12V transformer shall be installed within the main globe enclosure.
- Position all electrical cables; (a) to be well clear of the globe and any 12V transformer, and (b) to ensure safe conditions in the ceiling.
- Isolite™ is a heat exchange system and must not be buried. Thermal insulation must be installed in a manner that allows the required clearances to the Isolite™ system and any 12V transformer *to be maintained in the future* (see fig. 1). If this may not be possible then you must install the correct Isolite Heat Exchange Spacer accessory to completely surround the fully installed Isolite™ system down to a flat ceiling surface. Follow instructions for IHES1 and IHES2 closely. NOTE: Take professional advice if excessive roof space ventilation could cause movement of loose insulation in a hazardous manner in windy conditions. This is a building design oversight and should be rectified immediately.

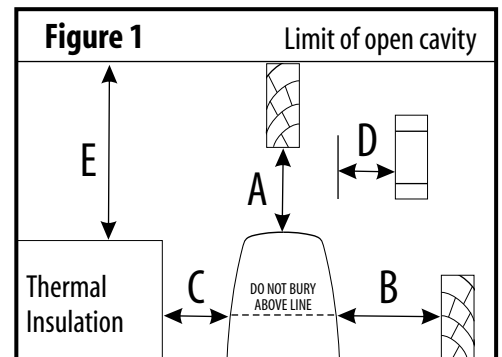

	Dimension (as per Figure 1)	Minimums for 12V	Minimums for 240V
A.	Isolite™ top clearance to structural member	10mm	10mm
B.	Isolite™ sides clearance to structural member	Nil	Nil
C(1).	Isolite™ sides clearance to fixed <i>batt insulation</i> below 50mm Isolite™ sides clearance to fixed <i>batt insulation</i> above 50mm	Nil Clear	15mm OR use IHES Clear OR use IHES
C(2).	Isolite™ sides clearance to <i>loose fill insulation</i> below 50mm line Isolite™ sides clearance to <i>loose fill insulation</i> above 50mm line	Nil Clear (Angled) OR use IHES	15mm (Angled) OR use IHES Clear (Angled) OR use IHES
D.	Required Transformer clearance to Isolite™ Guard	10mm Avg.	N/A
E.	Required open airspace above adjacent bulk insulation	50mm	50mm

Key : Avg. = Average Angled = Angled away at 45° Isolite™ = Guard (and Transformer Isolator option) 50mm = height of line on Isolite™
IHES = Isolite™ Heat Exchange Spacer Accessory (Guard only:use IHES1 only) (Guard and Transformer Isolator only: use IHES2). Follow IHES instructions closely

Note: If above ceiling access or other space constraints limit the use of Isolite™, contact Arrowform about other quality alternative products.

ISOLITE™ DOWNLIGHT ENCLOSURE INSTALLATION INSTRUCTIONS (Page 2)

Step 1

Do not begin Isolite™ instalation without following *all* warnings and instructions including the reverse side of this leaflet (page 1). You *must* closely follow the dimension table and the diagram in fig. 1.

Step 2

Select a Downlight Guard to suit the downlight cut-out size. If required trim out base rings to increase cut-out size with eg. tin snips (see warning 4).

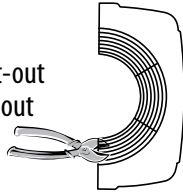

Step 3

Carefully remove completely, the smallest, most conveniently located male cable entry plug to suit the diameter of the downlight cables. Leave enough cable length for easy globe service. Place the halves around a clean recessed downlight (see warning 6).

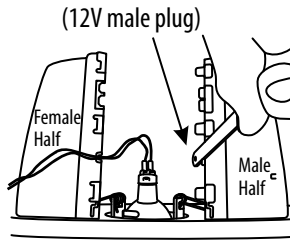

Step 4

Lift the downlight clips onto the Guard base halves (where practical) for secure Guard anchorage to the ceiling. If this is not practical you *must* follow the specified alternative method of fastening with due care (see warning 5).

Note: 240V female cable entries

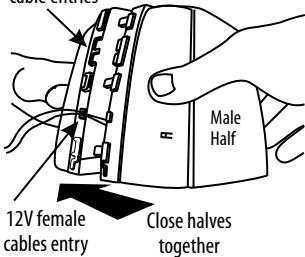

The complete Isolite™ Guard Assembly

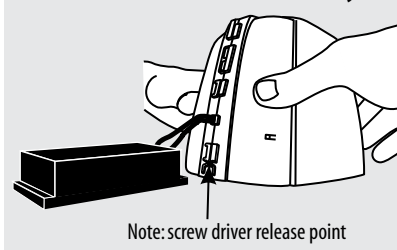

Step 5

For 12V installations securely attach the Transformer Isolator Accessory to the main housing with the transformer installed within. Position mains power cable through top cable exit point on the Transformer Isolator.

a) Transformer installation in Isolite™ Transformer Isolator



b) A slight lift of the Guard facilitates Transformer Isolator attachment



c) The complete Isolite™ Guard and Transformer Isolator assembly

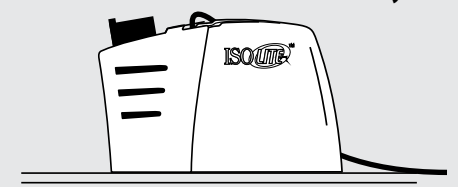

ATTENTION: INSTALLER, PROPERTY OWNER & ALL 'TRADIES' WHO DO ANYTHING IN THIS CEILING

Read these instructions before anything is done to any recessed downlight, or adjacent insulation or building materials in this ceiling.
(See warning 8 on page 1 re thermal insulation).

Pin a copy of this leaflet to eg. timber with *this* panel exposed, next to any ceiling access door where it can be easily seen and read as a safeguard against interference. **Report any obvious interference (including rodents, birds, etc) to the owner.**

Modifications required to use with 240V: GU10 CFL'S;



To use Isolite™ Guard for enclosure of 7-18 watt mini compact fluorescent globes only, you must install these heat resistant labels around the 240V cable of the fitting (see pic on left) so it can be easily read by a person who changes the globe. (Otherwise you must ventilate as required below). Insulation clearances required are different (see Fig 1).

All other 240V downlights;

To use Isolite™ Guard for enclosure of over 18 watt globes the Guard must be ventilated as follows; Following safe practices, carefully drill at least 6 x (7mm diameter only) holes at the top of each side, just above the Isolite™ logo (see pic on left) giving a total of 12 separate holes per assembled Guard. (Note: This modification renders the Guard unsealed, and consequently reduces the benefits). Insulation clearances required are different (see Fig 1).

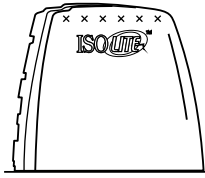

Isolite™ is Manufactured in Australia by:

ARROWFORM

Engineered Products for the future

5 Richards Road (PO Box 949)
Swan Hill Victoria 3585 Australia
Phone: (03) 5032 4666 Fax: (03) 5032 5255

For further details on Isolite™ Guard & Transformer Isolator contact
Arrowform on 1800 852 741

Isolite™ Manufacturers Warranty

Isolite™ is guaranteed to be free from defects in material and workmanship for a period of twelve months from the date of purchase. Note that Isolite may discolour, particularly where it is in contact with insulation materials without affecting its performance. Deliberate mis-use or installation not in accord with written product installation instructions shall void any claim. All claims subject to verification by Arrowform and limited to product replacement only. Claims must be accompanied by original receipt.

Disclaimer: Arrowform and Isolite™ carry no responsibility for the quality or suitability of downlight assemblies used in conjunction with Isolite™.